

NOTES:  
 1. DO NOT SCALE. USE FIGURED DIMENSIONS ONLY.  
 2. THIS DRAWING IS TO BE READ IN CONJUNCTION WITH ALL OTHER RELEVANT ARCHITECTURAL AND ENGINEERING DRAWINGS.

**LEGEND:**

- FS ——— FS EXISTING FOULED WATER SEWER WITH PIPE SIZE, GRADE, MANHOLE REF. AND INVERT LEVEL
- EXS ● EXS EXISTING SURFACE WATER FILTER DRAIN WITH PIPE SIZE, AND INVERT LEVEL
- IL X IL X
- SW ——— SW

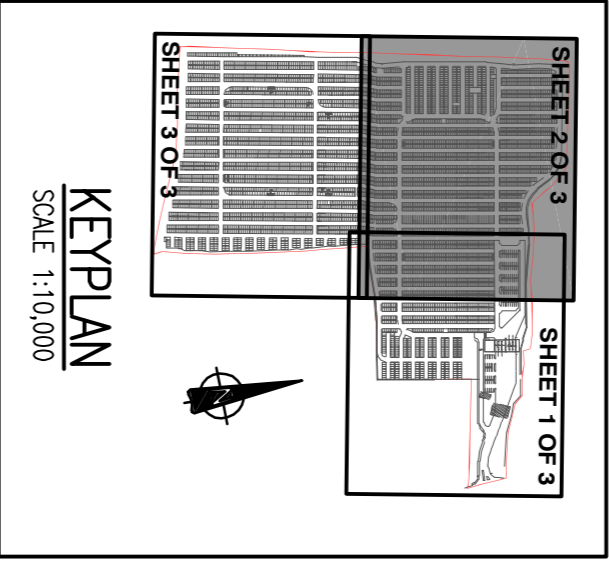

NOTE:  
 PLEASE REFER TO DRAINAGE CATCHMENTS ON DRAWING NO. 15-194 P024

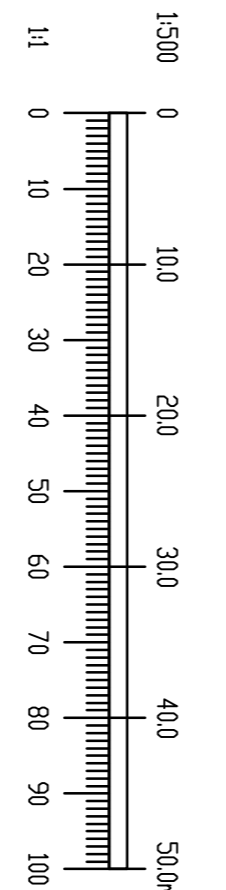

Ordnance Survey Ireland Licence No. EN 0006018  
 © Ordnance Survey Ireland/Government of Ireland.

REV.	DATE	AMENDMENT	DRN	APPD

**FOR PLANNING NOT FOR CONSTRUCTION**

**Waterman Moylan**  
 Engineering Consultants  
 BLOCK 5, EASTPOINT BUSINESS PARK, ALTE RYNE ROAD,  
 TULLAGH, DUBLIN 18  
 Email: info@waterman-moylan.ie www.waterman-moylan.ie

CLIENT: GERARD GANNON  
 ARCHITECT: WILSON ARCHITECTURE  
 PROJECT: QUICKPARK CAR PARK AT TURNAMIN GREAT, SWORDS ROAD.

TITLE: EXISTING AND PROPOSED DRAINAGE LAYOUT  
 SHEET 2 OF 3

DESIGNED	APPROVED	DATE
PJD	MD	SEPT 18'

SCALE	DRG. NO.	REVISION
1:500 @ A1	P022	

Drawing Location: K:\Projects\15-194\15-194\_P022\_P023\_Planing & Proposed Drainage Layouts.dwg  
 2017: No liability is accepted for any error or omission in this drawing or for any loss or damage of any kind, howsoever caused, arising from the use of this drawing.